

CABINET FEET

CABINET FEET

Can be used as an alternative to plinth panels.

Cabinet foot

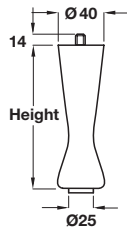

- > With M10 threaded bolt
- > For installation with screw-in sleeve or mounting plates shown below
- > Polished aluminium with plastic glide
- > Order qty: 1 pc



Order screw-in sleeve or mounting plate separately, shown below

Height	Cat. No.
140 mm	634.18.002

M10 screw-in sleeve

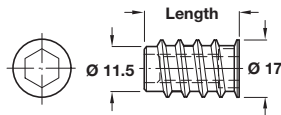

- > With SW8 hexagon socket head
- > With rim
- > Galvanized steel
- > Order qty: Multiples of 100 pcs

Length	Cat. No.
20 mm	030.10.906

Mounting plate, round

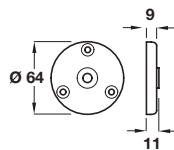

- > With M10 tapped hole for installation of cabinet foot
- > Adds 9 mm to installation height of cabinet foot
- > Aluminium
- > Order qty: 1 pc



Finish	Cat. No.
Polished aluminium	634.15.091

Mounting plate, triangular

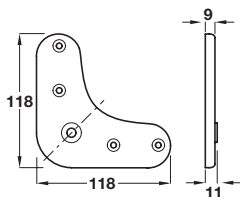

- > With M10 tapped hole for installation of cabinet foot
- > Adds 9 mm to installation height of cabinet foot
- > Aluminium
- > Order qty: 1 pc



Finish	Cat. No.
Polished aluminium	634.15.092



Load carrying capacity is dependent on the type of material, size and weight of the construction