

REAR PANEL CONNECTORS

Rear panel connector

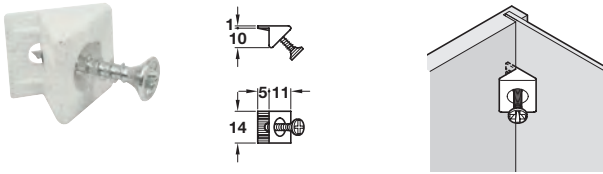

- > Screw fixing
- > Plastic
- > Order qty: Multiples of 100 pcs



Finish	Cat. No.
White	260.03.700

Rear panel connector

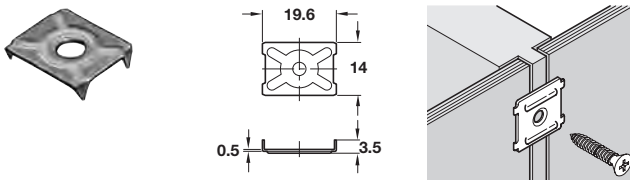

- > Provides rapid and simple attachment of two rear panels to a centre partition
- > Steel
- > Order qty: Multiples of 100 pcs



Finish	Cat. No.
Bright	260.01.007

Rear panel fastening screw

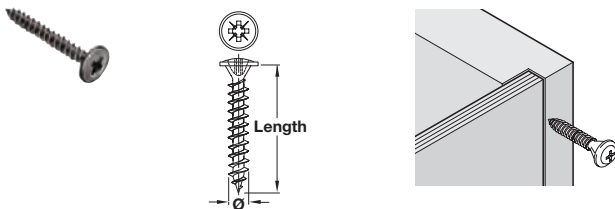

- > With large head and Pozidriv cross-slot, size 2
- > For direct screw mounting of the rear panel
- > Galvanized steel
- > Order qty: Multiples of 1000 pcs

Thread Ø	Length	Cat. No.
Ø 3 mm	20 mm	016.10.555
Ø 3 mm	25 mm	016.10.573

Rear panel connector

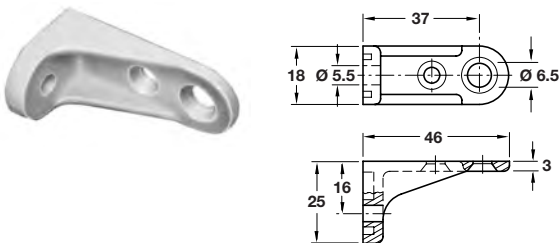

- > Fastens to rear panel with Hospa screw
- > Direct fixing to cabinet side panel with Varianta screw
- > An additional screw can be used to increase stability
- > Plastic
- > Order qty: Multiples of 100 pcs



Finish	Cat. No.
White	260.13.721

- > Hospa screws are shown on pages 388-393, 402
- > Varianta screws are shown on pages 400-401, 403