

IXCONNECT RAFIX-20 CONNECTOR HOUSINGS

ixconnect

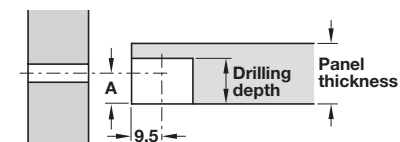
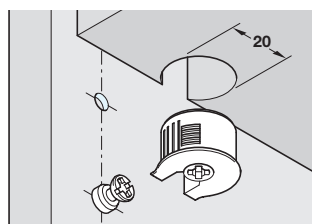

Drilling depth X = depends on type of housing and wood thickness (see order columns for details)
Dimension A = 1/2 wood thickness (see order columns for details)

**Without ridge:**

The horizontal panel can be installed end-on or from above

With ridge:

The horizontal panel can only be installed from above and the cabinet elements are pre-assembled

Rafx-20 housing, zinc alloy

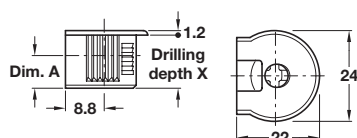

- > For wood thickness from 16 or 19 mm
- > Drive: PZ2 cross slot
- > Zinc alloy housing with zinc alloy tightening element
- > Order qty: Multiples of 100 pcs

For wood thickness from	Dim. A	Drilling depth X	Nickel-plated	Burnished
Without ridge				
16 mm	8.0 mm	12.7 ^{+0.2} mm	263.11.703	263.11.103
19 mm	9.5 mm	14.2 ^{+0.2} mm	263.11.705	263.11.105
With ridge				
16 mm	8.0 mm	12.7 ^{+0.2} mm	263.15.703	-
19 mm	9.5 mm	14.2 ^{+0.2} mm	263.15.705	263.15.105

Rafx-20 housing, plastic

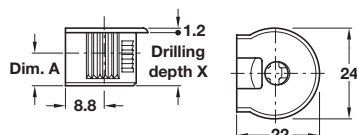

- > For wood thickness from 16 mm or 19 mm
- > Drive: PZ2 cross slot
- > Plastic housing with zinc alloy tightening element
- > Order qty: Multiples of 100 pcs

Dim. A	Drilling depth X	White	Beige	Brown	Black	Silver coloured
Without ridge - for wood thickness from 16 mm						
8.0 mm	12.7 ^{+0.2} mm	263.10.703	263.10.403	263.10.103	263.10.303	263.10.203
Without ridge - for wood thickness from 19 mm						
9.5 mm	14.2 ^{+0.2} mm	263.10.705	263.10.405	263.10.105	263.10.305	-
With ridge - for wood thickness from 16 mm						
8.0 mm	12.7 ^{+0.2} mm	263.14.703	263.14.403	263.14.103	-	-
With ridge - for wood thickness from 19 mm						
9.5 mm	14.2 ^{+0.2} mm	263.14.705	263.14.405	263.14.105	-	-

Rafx-20 flush-fitting housing, plastic

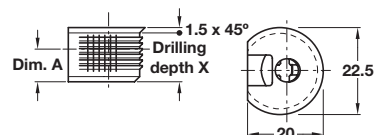

- > For wood thickness from 16 or 19 mm
- > Drive: PZ2 cross slot
- > Plastic housing with zinc alloy tightening element
- > Order qty: Multiples of 100 pcs

Dim. A	Drilling depth X	White	Beige	Brown	Black	Aluminium col.
Without ridge - for wood thickness from 16 mm						
8.0 mm	12.7 ^{+0.2} mm	263.50.703	263.50.403	263.50.103	-	263.50.203
Without ridge - for wood thickness from 19 mm						
9.5 mm	14.2 ^{+0.2} mm	263.50.705	263.50.405	263.50.105	263.50.305	-

Rafx-20 flush-fitting housing trim cap

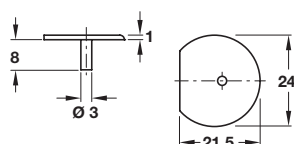

- > For Rafx-20 flush-fitting housings 19 mm wood thickness only
- > Plastic
- > Order qty: Multiples of 100 pcs

Finish	Cat. No.
White	263.59.730