

Shelf support, plug in, for Ø 5 mm holes

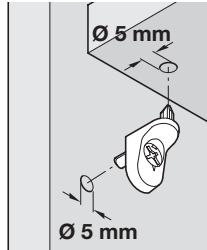
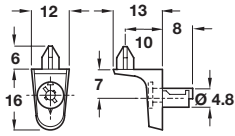

Not suitable for hardwood

- > For applications that require increased side stability, suitable for all types of furniture
- > The pre-installed speed mount element allows a swift and easy installation into Ø 5 mm system holes by turning the element 180° with a screw driver
- > Ø 5 mm hole won't be damaged, therefore allowing multiple installation/dismantling
- > For Ø 5 mm hole
- > Load carrying capacity 75 kg*
- > Zinc alloy
- > Order qty: Multiples of 100 pcs

Finish	Cat. No.
Nickel-plated	282.26.715

Shelf support, plug in, for Ø 5 mm holes

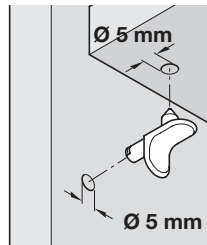
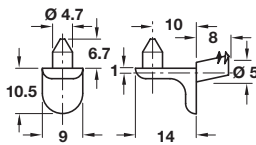

- > With recessed seat, twin grooves and shelf-fixing lug
- > For Ø 5 mm hole
- > Load carrying capacity 125 kg*
- > Zinc alloy
- > Order qty: Multiples of 100 pcs

Finish	Cat. No.
Nickel-plated	282.24.720

Shelf support, plug in, for Ø 5 mm holes

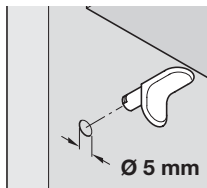
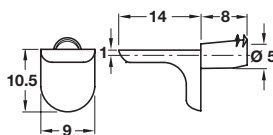

- > With twin grooves
- > For Ø 5 mm hole
- > Load carrying capacity 125 kg*
- > Zinc alloy
- > Order qty: Multiples of 100 pcs

Finish	Cat. No.
Nickel-plated	282.24.710

Shelf support, plug in, with thread, for Ø 5 mm holes

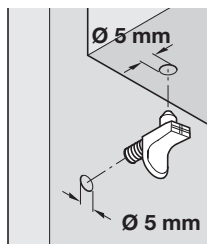
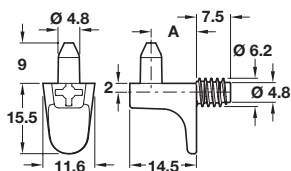

- > With shelf-fixing lug
- > For turning into Ø 5 mm hole
- > Load carrying capacity 80 kg**
- > Nickel-plated zinc alloy
- > Order qty: Multiples of 100 pcs

Lug distance A	Cat. No.
10 mm	282.26.706
12 mm	282.26.701



*Load carrying capacity applies to 4 shelf supports bearing an evenly distributed load. Testing was carried out according to DIN EN 1727:1998-06 "Mechanical safety requirements for shelf supports"

**Load carrying capacity applies to 4 shelf supports bearing an evenly distributed load. Testing was carried out according to DIN EN 16337:2013 "Mechanical safety requirements for shelf supports"