

Flap hinge

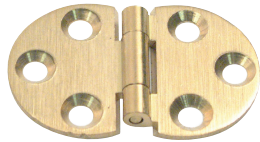

- > Economy model
- > Opening angle 270°
- > Ø 30 mm cup
- > Screw fixing
- > Brass or steel cup and arm
- > Order fixing screws separately
- > Order qty: 1 pc

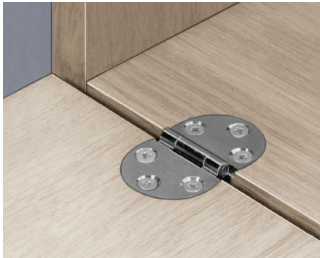
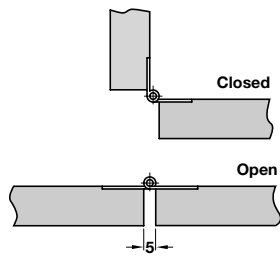
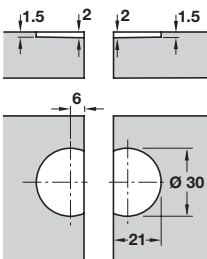
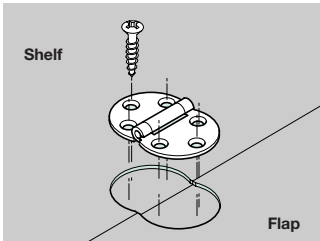

| Finish | Brass | Steel |
|------------------------|------------|------------|
| Matt brass | 342.63.502 | - |
| Polished nickel-plated | 342.63.600 | 342.62.710 |

Plano medial flap hinge



- > Opening angle 90°
- > Ø 30 mm cup
- > Screw fixing
- > Three sizes for 15-19 mm flap thickness
- > Flush fitting
- > Zinc alloy/plastic or zinc alloy cup and brass arm
- > Order fixing screws separately
- > Order qty: 1 pc

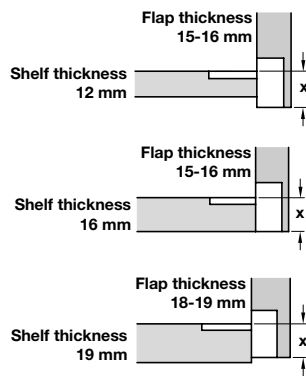
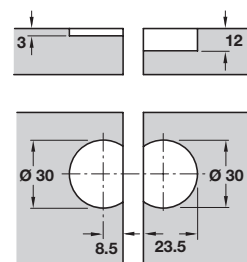
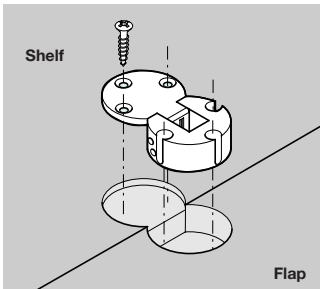

| Finish | Dim x | Cat. No. |
|---------------------|-------|------------|
| Zinc alloy/plastic | | |
| Chrome-plated/white | 14 mm | 342.75.226 |
| Zinc alloy | | |
| Nickel-plated | 16 mm | 342.75.628 |
| Burnished | 16 mm | 342.75.128 |

DRAWER SYSTEMS, STAYS AND HINGES 2015. © Häfele U.K. Ltd 2015. Dimensional data not binding. We reserve the right to alter specifications without notice.