

K PUSH WITH RAIL

Push system for opening doors without handles.

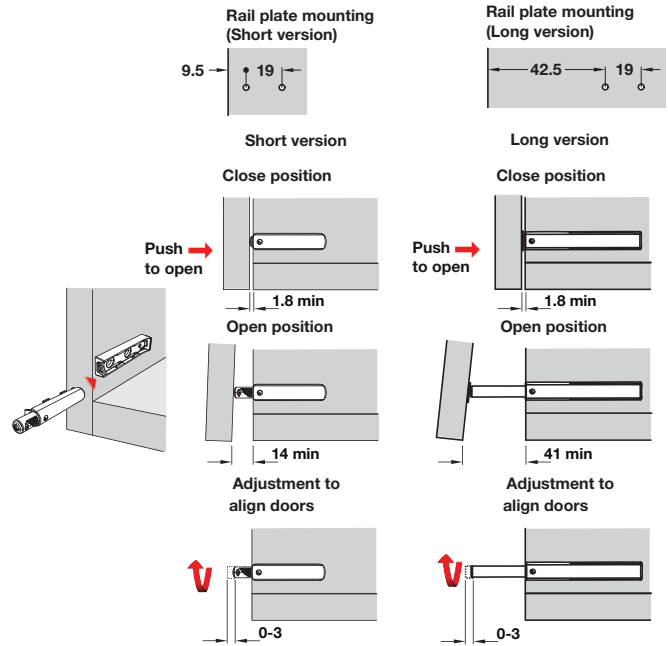

K Push and plate - short or long version

K Push short with magnet



K Push short with buffer

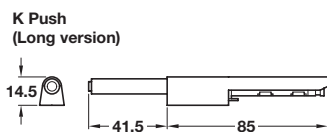
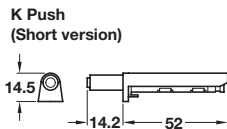

Rail plate

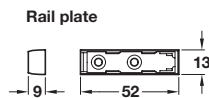

Adhesive plate for magnet



Plate for magnet

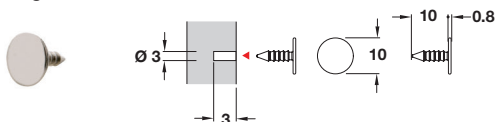

- > Available either with magnet or with buffer
 - Order magnet version for cabinets using unsprung hinges (order plate for magnet separately)
 - Order buffer version for cabinets using sprung hinges
- > Screw fixing rail plate with wood screws (screws not included)
- > K Push slides onto rail plate and clicks in
- > Important: please do not press or release the spring until the K Push is fully installed
- > Grey or black engineering plastic with magnet or rubber buffer
- > Order K Push and rail plate separately
- > Order fixing screws separately
- > Order qty: 1 pc



K Push type	Grey	Black
K Push - short version		
With buffer	356.01.501	356.01.301
With magnet	356.01.511	356.01.311
Rail plate	356.01.519	356.01.319
K Push - long version		
With buffer	356.01.502	356.01.302
With magnet	356.01.512	356.01.312
Rail plate	356.01.519	356.01.319
Cat. No.		
Adhesive plate for magnet	356.01.539	
Plate for magnet, with Ø 3 mm pin	356.01.549	