

# INTEGRATO, FOR ALIGNING HEAVY FURNITURE

The mounting plate of the Integrato foot has spikes which are easily hammered onto cabinet bottom edge, then secured by screws (not included). With black plastic glide to prevent floor scratching.

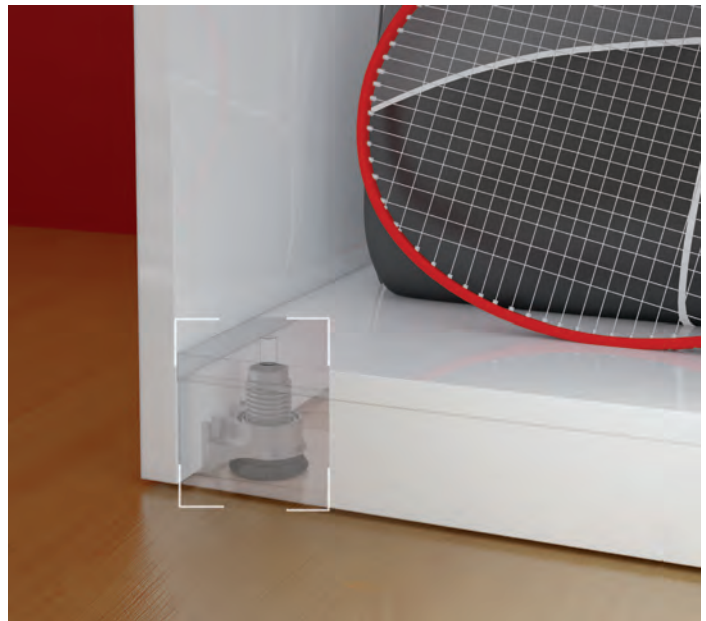

## Integrato G adjustable foot

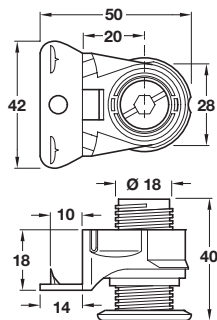
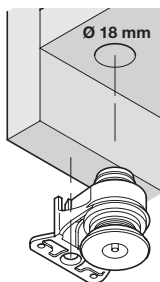

- > For aligning heavy duty wardrobes, bookcases, modular furniture
- > Plate has spikes which are easily hammered onto cabinet bottom edge, then secured in position by a countersunk 18 mm length screw from underneath first and also 2 panhead x 18 mm length screws from the side secondly if required.
- > Ø 8 mm through hole in the base of the cabinet, allows you to adjust the leveller from the above, by using a SW6 hex key or both cross and blade screwdriver (Ø 12 mm through hole required for screwdriver access)
- > 25 mm adjustment
- > Independent black plastic glide to prevent floor scratching
- > Zinc alloy
- > Order qty: 1 pc



Load capacity  
175 kg

Cat. No.  
637.67.910

## Integrato G adjustable foot

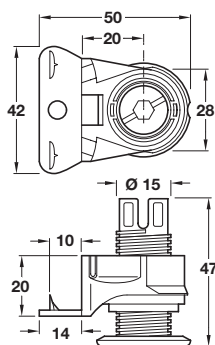
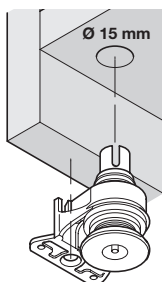

- > For aligning heavy duty wardrobes, bookcases, modular furniture
- > Plate has spikes which are easily hammered onto cabinet bottom edge, then secured in position by a countersunk 18 mm length screw from underneath first and also 2 panhead x 18 mm length screws from the side secondly if required
- > Ø 8 mm through hole in the base of the cabinet, allows you to adjust the leveller from the above, by using a SW6 hex key or a blade screwdriver (Ø 12 mm through hole required for screwdriver access)
- > 25 mm adjustment
- > Independent black plastic glide to prevent floor scratching
- > Plastic
- > Order qty: 1 pc



Load capacity  
175 kg

Cat. No.  
637.67.920