



Rafix is based on the self centring bolt principle (as is Minifix). This makes it extremely strong and always correctly aligned.

Tightening distances:

All drilling operations are made on flat surfaces. Concealed mounting is possible because of the specially designed tightening element.

Rafix housings have two types of recess to accommodate the connecting bolt:

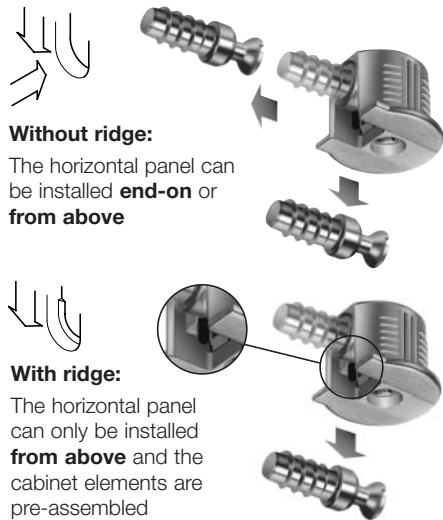

Without ridge:

The horizontal panel can be installed **end-on** or **from above**

With ridge:

The horizontal panel can only be installed **from above** and the cabinet elements are pre-assembled

The Rafix range consists of:

- **Housings**
- **Flush fitting housings;** countersunk rim giving no projection onto the panels
Plastic version only, suitable for 16 and 19 mm board thicknesses
- **Standard fitting housings;** with and without a 32 mm dowel. Metal and plastic versions, suitable for 16 and 19 mm board thicknesses
- The 32 mm dowel version is recommended where extra strength and support is required.
- Both standard and flush fitting housings are available with and without ridge
- **Tab fixing housings;** an addition to the range intended primarily for shelf connection. The same drilling pattern and the same range of bolts is used. Tab fixes with a catch which is different from other Rafix fittings. Plastic version suitable for 16 mm board thickness only
- **Connecting bolts**
- \varnothing 7 mm connecting bolts suitable for all Rafix fittings, pages **30-33**

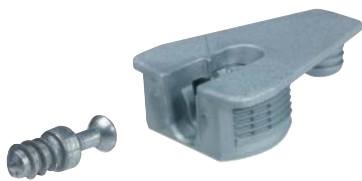

- **Rafix SH 30 KD fittings, range consists of:**
- **Housings** - similar in design to Rafix-SE 32 housing but **for \varnothing 30 mm drill hole**, with dowel for \varnothing 10 mm hole
- **Connecting bolt** - standard Rafix bolts **can not** be used with Rafix SH 30 housings, only special Rafix 30 bolt can be used

Housings

Standard housings, Page 28

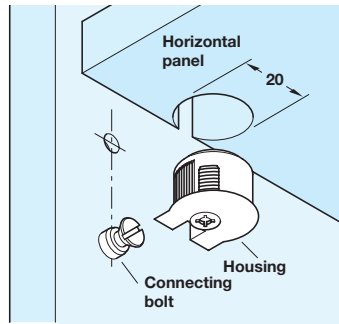

Flush fitting housings, Page 28

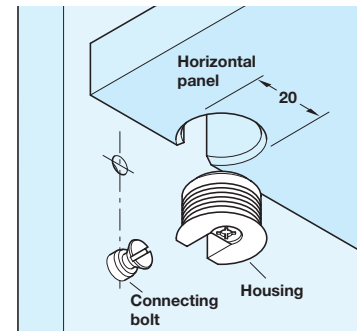

Standard housings, 32 mm version, Page 29

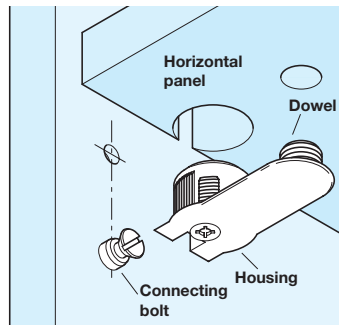

Rafix TAB housings, Page 30

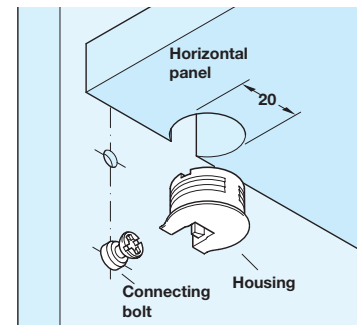

Connecting bolts

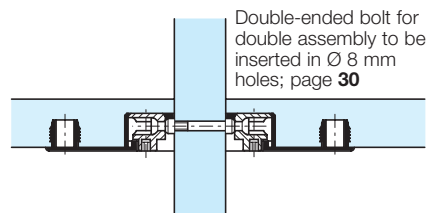
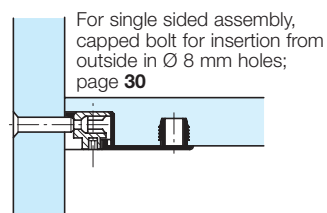
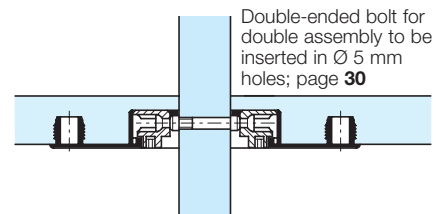
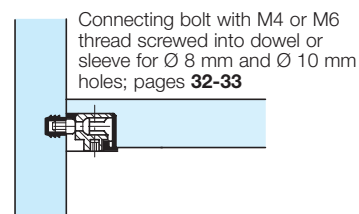
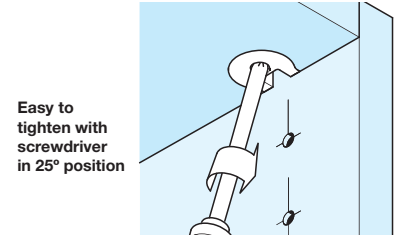
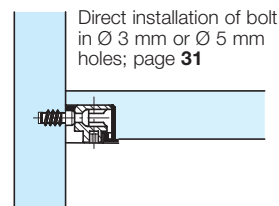

Rafix SE 30 housings, 32 mm version, Page 34

